

STM125-7.5-ER32

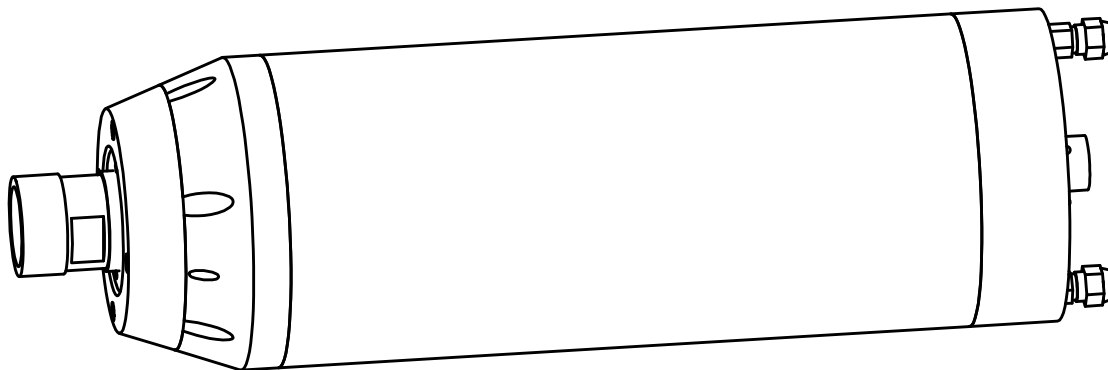
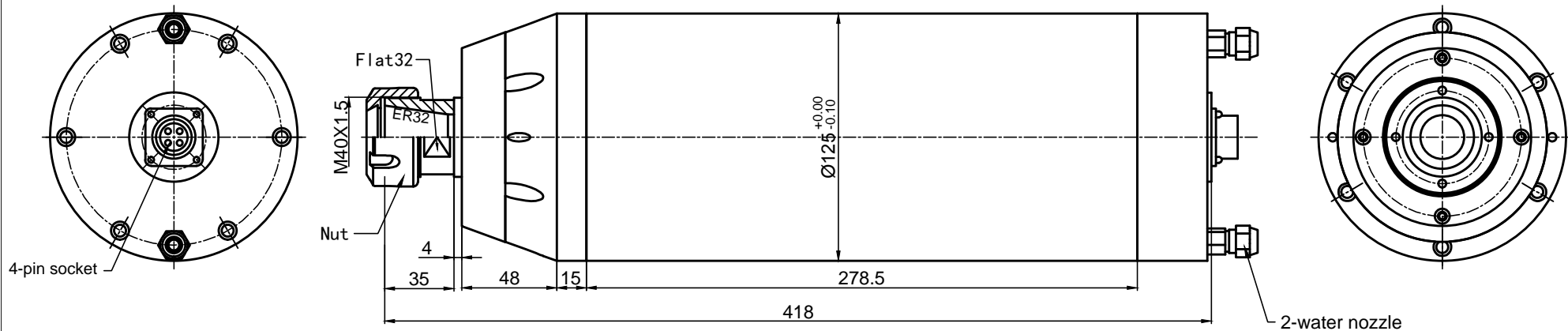

**【CAUTION】**

Rotating mode: anticlockwise from the shaft extension end

WHD SPINDLE MOTOR							
Power	Voltage	Current	Shaft	Frequency	Speed	Cool	Weight
7.5KW	380V	16A	ER32	800Hz	24000RPM	Water	26.5KG